



EMERALD CRUISES

# Emerald Star Ship

## RADIANCE

— INCLUSIONS —

- Transfers on group travel days
- Gratuities and port charges
- Complimentary Wi-Fi
- All on board meals in the Reflections Restaurant and a selection of meals during touring days onboard meals
- EmeraldEXCURSION almost every day
- Expert local guides
- Complimentary beer, wine, and soft drinks to accompany lunch and dinner
- Unlimited coffee from state-of-the-art coffee machines
- Bottled water restocked daily in your cabin
- Onboard entertainment

### LUXURY DOURO RIVER CRUISES

*Emerald Radiance* is your home away from home, a boutique floating hotel that provides guests with luxurious surroundings, a wealth of amenities, and unique innovations such as the spa-style Serenity Pool on the Sun Deck.

Escape to your private sanctuary of serenity. With a range of suites and staterooms, there's a cabin option to suit all preferences and budgets, whether you need plenty of space to stretch out, or you're longing for a cozier accommodation.

Enlightening experiences await on your Portugal river cruise. Sample Port wine along the Douro River, tour the natural beauty of the Douro Valley, and discover historic art and monuments depicting ancient settlements in the region.

GO NEXT  
PERKS

- **With Go Next you get more** - from the time you book a trip to your welcome home
- Reception with appetizers, wine, beer, and soft drinks
- Joining every trip, a Go Next Program Manager is your traveling attendant on board and off
- As experts in group and independent travel, Go Next ensures you will be taken care of
- More for your money on any budget. Get the best value with exclusive cruise line partners traveling to some of the most elite destinations
- Become one of the thousands of pleased guests who have traveled with Go Next over the last 50 years
- Sail with a team that is adaptable, responsive, and has delivered guest satisfaction year after year







## DISTINCTIONS

- From world-class cuisine and blissful spa treatments to the spa-style Serenity Pool, cruise the Douro River in comfort and relaxation.
- In the Horizon Bar & Lounge, sip your morning tea or coffee, and later, enjoy the evening's entertainment with friends.
- Head to the Reflections Restaurant to enjoy delectable dining on board or visit the Lounge to relax as you watch the horizon unfold.
- Visit the Fitness Area to get your heart racing, or, in the Wellness Area, indulge in a special spa or hair treatment<sup>^</sup>.

## — ACCOMMODATIONS —

<b>Emerald Radiance</b>	<b>RA</b>	<b>SA</b>	<b>P</b>	<b>A, B, C</b>	<b>R</b>	<b>D, E, F</b>
<b>Square Footage</b>	300	285	170	160	188	153-170
<b>Walk-in wardrobe</b>	•	•				
<b>Separate lounge and bedroom area</b>	•	•				
<b>Private Terrace</b>	•	•				
<b>Complimentary in-suite mini-bar</b>	•	•				
<b>In-suite Nespresso™ machine</b>	•	•				
<b>Indoor Balcony with open-air system</b>			•	•	•	
<b>Port-hole Window</b>						•
<b>Complimentary bathrobes and slippers</b>	•	•	•	•	•	•
<b>Individual climate control</b>	•	•	•	•	•	•
<b>Flat screen TV and infotainment system</b>	•	•	•	•	•	•
<b>Complimentary Wi-Fi</b>	•	•	•	•	•	•

<sup>^</sup>Available at an additional cost.

# EMERALD RADIANCE DECK PLAN

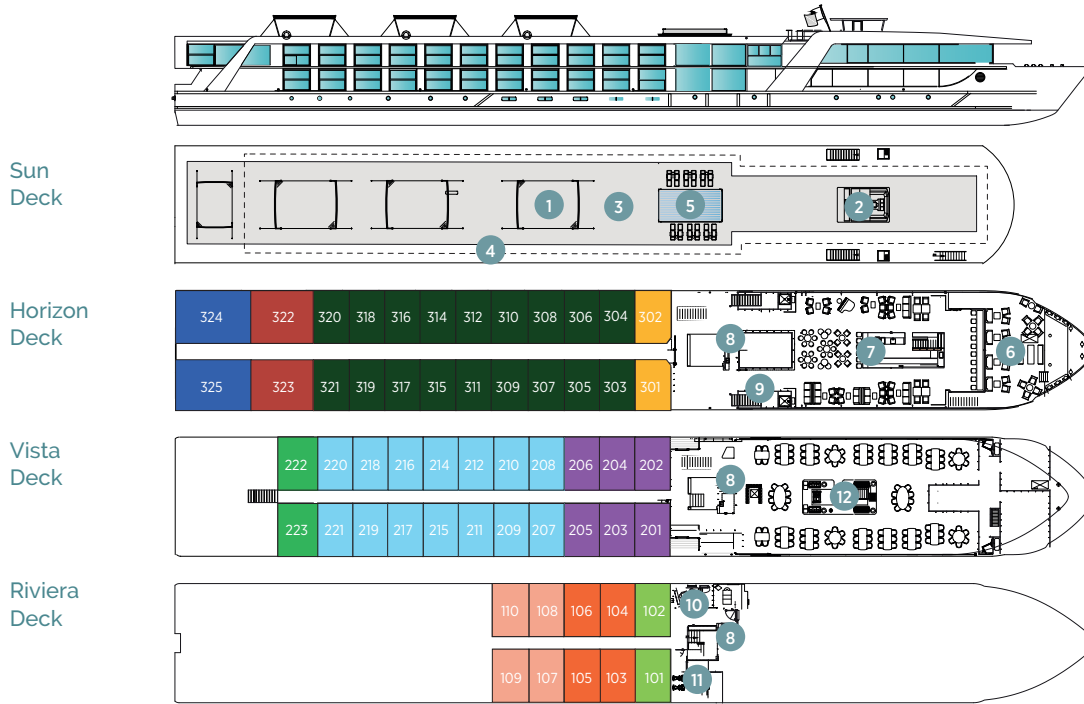

- 1 Sun Deck with Deck Chairs<sup>^</sup>
- 2 Navigation Bridge
- 3 Sky Barbecue
- 4 Golf Putting Green
- 5 Games Area
- 6 Retractable Glass Roof
- 7 Walking Track
- 8 Daytime Pool & Bar/Evening Cinema
- 9 The Terrace
- 10 Horizon Bar & Lounge
- 11 Elevator
- 12 Reception

## Stateroom Categories

CAT	Horizon Deck	QTY	Size ft <sup>2</sup> (m <sup>2</sup> )	CAT	Riviera Deck	QTY	Size ft <sup>2</sup> (m <sup>2</sup> )	CAT	Vista Deck	QTY	Size ft <sup>2</sup> (m <sup>2</sup> )
RA	Emerald Riverview Suite	2	300ft <sup>2</sup> (27.9m <sup>2</sup> )	R	Emerald Panorama Balcony Suite	2	188ft <sup>2</sup> (17.5m <sup>2</sup> )	D	Emerald Stateroom	2	170ft <sup>2</sup> (15.8m <sup>2</sup> )
SA	Owner's One-Bedroom Suite	2	285ft <sup>2</sup> (26.5m <sup>2</sup> )	B	Emerald Panorama Balcony Suite	6	160ft <sup>2</sup> (14.9m <sup>2</sup> )	E	Emerald Stateroom	4	160ft <sup>2</sup> (14.9m <sup>2</sup> )
P	Emerald Panorama Balcony Suite	2	170ft <sup>2</sup> (15.8m <sup>2</sup> )	C	Emerald Panorama Balcony Suite	14	160ft <sup>2</sup> (14.9m <sup>2</sup> )	F	Emerald Stateroom	4	153ft <sup>2</sup> (14.3m <sup>2</sup> )
A	Emerald Panorama Balcony Suite	18	160ft <sup>2</sup> (14.9m <sup>2</sup> )								

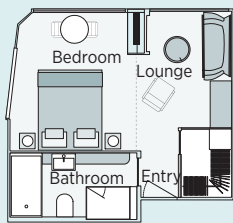

**Emerald Riverview Suite**  
300ft<sup>2</sup> (27.9m<sup>2</sup>)  
**CAT RA**

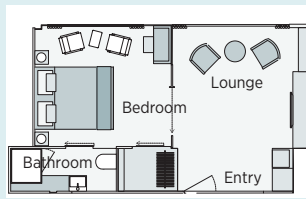

**Owner's One-Bedroom Suite**  
285ft<sup>2</sup> (26.5m<sup>2</sup>)  
**CAT SA**

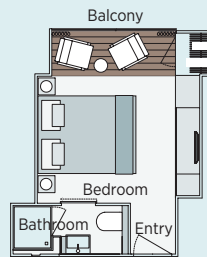

**Emerald Panorama Balcony Suite**  
188ft<sup>2</sup> (17.5m<sup>2</sup>) - 160ft<sup>2</sup> (14.9m<sup>2</sup>)  
**CAT P CAT A CAT R CAT B CAT C**

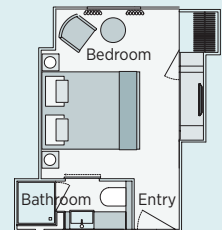

**Emerald Stateroom**  
153ft<sup>2</sup> (14.3m<sup>2</sup>) - 170ft<sup>2</sup> (15.8m<sup>2</sup>)  
**CAT D CAT E CAT F**